

# RFID L-Band stof armbånd



## RFID L-Band

RFID L-Band is a "L" Shape wristband with a plastic snap lock, that is easy to apply and very difficult to remove. It is classic design, soft and comfortable. The RFID chip is pouched secure inside the woven pouch. It soft and great feeling after wear on the wrist. It is widely used for high-end activities, conferences, music, concert and performances etc. The Fabric/Woven no harmful for humanbody and environment friendly.

### Product Details:

Frequency:125KHZ,13.56MHZ,UHF  
 Chip:EM4200/Mifare 1K/Mifare Ultralight/ICODE SLIX/Ntag213/Alien H3/Ultralight EV1/Mifare Plus SE 1K/Desfire/Mifare Ultralight C  
 Protocol:ISO14443/15693/NFC/18000-6C  
 Storage:Depends on the IC chip  
 Read/Write distance:Best tuning antenna for different IC chip  
 Erase cycle:≥100,000  
 Temperature: -40°C~+60°C  
 Size:350\*160mm/350\*20mm, 400\*16mm/400\*20mm  
 Waterproof  
 Material: Smart Card+Fabric Wristband/Woven Wristband  
 Smart Card : Hard PVC Or Soft PVC  
 Fabric Wristband: Full Color Print Fabric(2 sided print optional);



The wristband is adjustable and suitable for different wrist degrees.

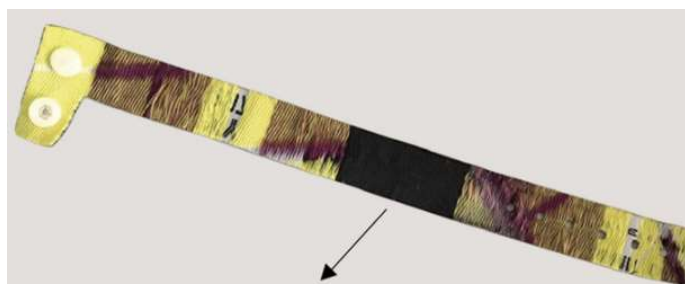
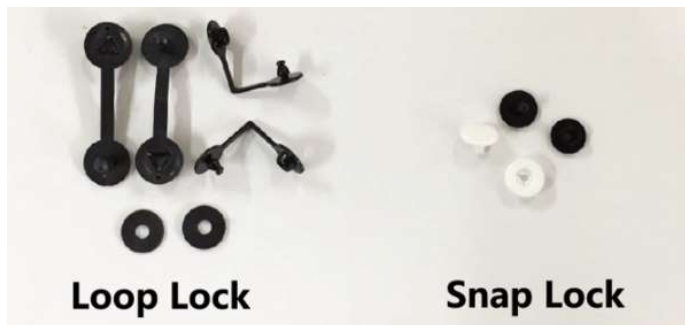

The RFID chip is pouched secure inside the woven pouch.

Woven Wristband:Maximum 8 Colors Woven;(Includes neon and metallic threads)

### Lock Type(Pantone matched lock):

Snap Lock(Single time use lock)

### Additional Features:

Serial number/Random Number Printing Match UID of RFID

For mere information kontakt os : <https://idekort.dk>

Mail : [kontakt@idekort.dk](mailto:kontakt@idekort.dk)